

Side Cut Metropark

Side Cut is one of nine natural area Metroparks totaling more than 9,056 acres. The Metropolitan Park District of the Toledo Area, a separate political subdivision of the State of Ohio, was founded in 1928 and is governed by a three-person Board of Park Commissioners who serve without pay. Funding for the operation and improvement of the Metroparks is derived chiefly from voter support of a small property tax levy.

In an emergency requiring ranger assistance, dial 911. A public telephone is located at the Lamb Heritage Center.

Metroparks are open daily, free of charge. Hours: 7 a.m. until dark.

Walleye Fishing Line (Mar.-Jun.) (419) 407-9700, option 2

Side Cut Metropark
1025 River Rd., Maumee, OH 43537

Emergencies: call 911

Program information:
419-407-9700
MetroparksToledo.com



METROPARKS
TOLEDO AREA

Your Choice. Safe. Natural. Places To Be.

Side Cut Metropark

770 Acres

Trails

Walking

Trail Name	Round Trip Miles
Riverview Trail/Orange	1.2
Canal Locks Trail/Blue	0.5
Fallen Timbers Trail/Red	4.1
Wood Duck Trail/Green	1.5
Wabash Cannonball Trail	

Cross Country Skiing

All walking trails may be used for skiing.

	Parkland
	Forested Area
	Pedestrian Walkway
	Trail Head
	Overlook

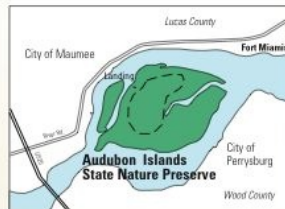
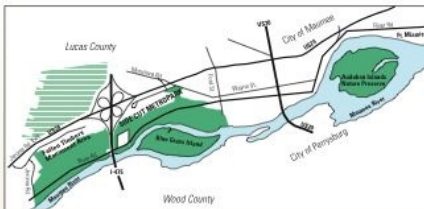
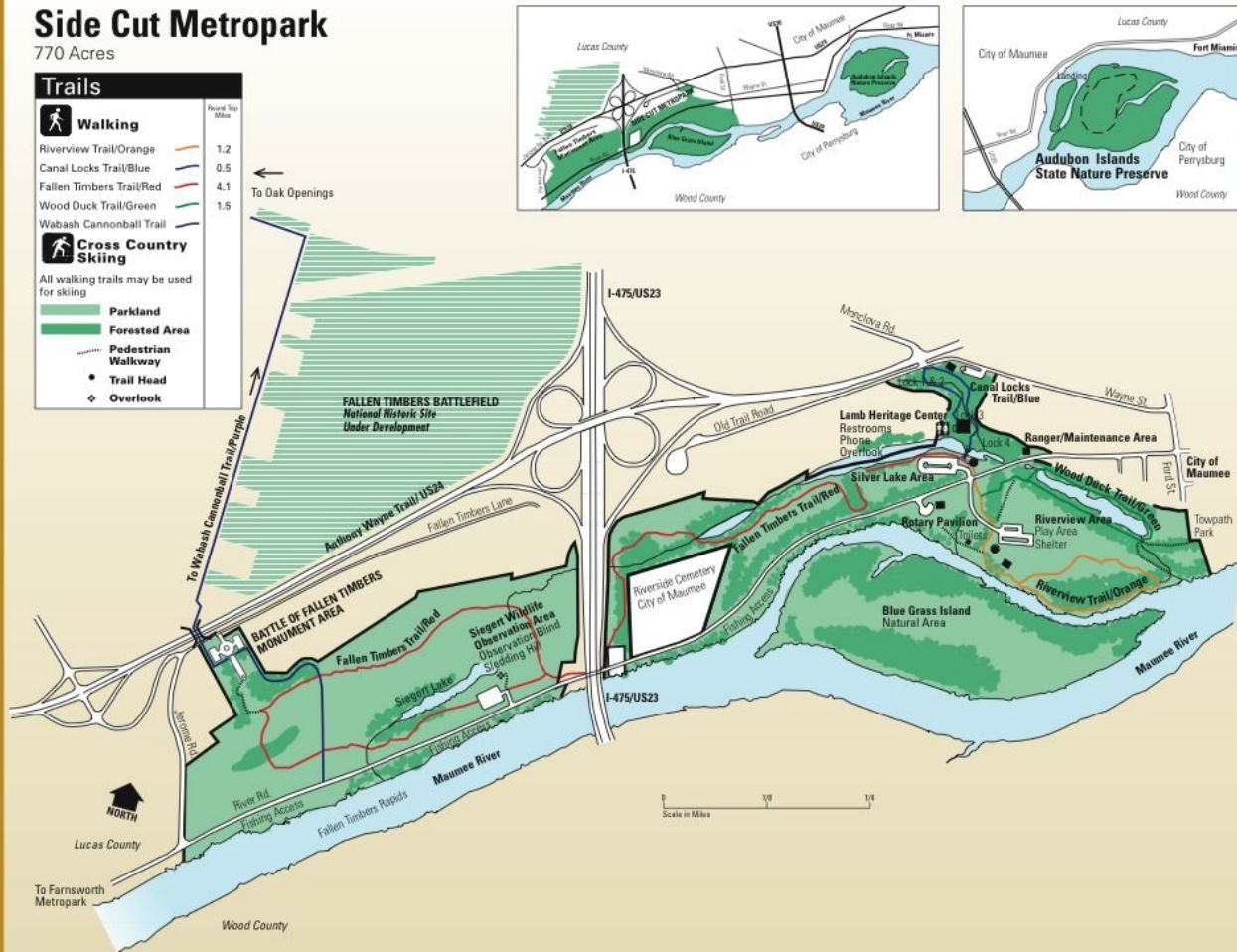

Trail Name	Round Trip Miles
Upland Woods Trail	2.3
Floodplain Trail	1.4
Ridge Trail	0.8
Meadow Trail	1.2
Prairie Trail	2.1
Corey Rd. Loop	0.6
	All Purpose Trail
	Brown 3.3
	University/Parks Trail
	One Way Miles
	Boardwalk (Floodplain Trail)
	Boardwalk (All Purpose Trail)
	Regional Bikeway
	Parking Lots 1-8

Cross Country Skiing

All walking trails may be used for skiing.

	Grassland & Thicket
	Forested Area
	Overlook
	Trailhead
	Information Plaza
	Trail Connector
	Boardwalk (Floodplain Trail)
	Boardwalk (All Purpose Trail)
	Regional Bikeway
	Parking Lots 1-8